



Stoughton Road, Guildford

In Excess of £349,995



GROUND FLOOR
331 sq.ft. (30.8 sq.m.) approx.

1ST FLOOR
322 sq.ft. (29.9 sq.m.) approx.

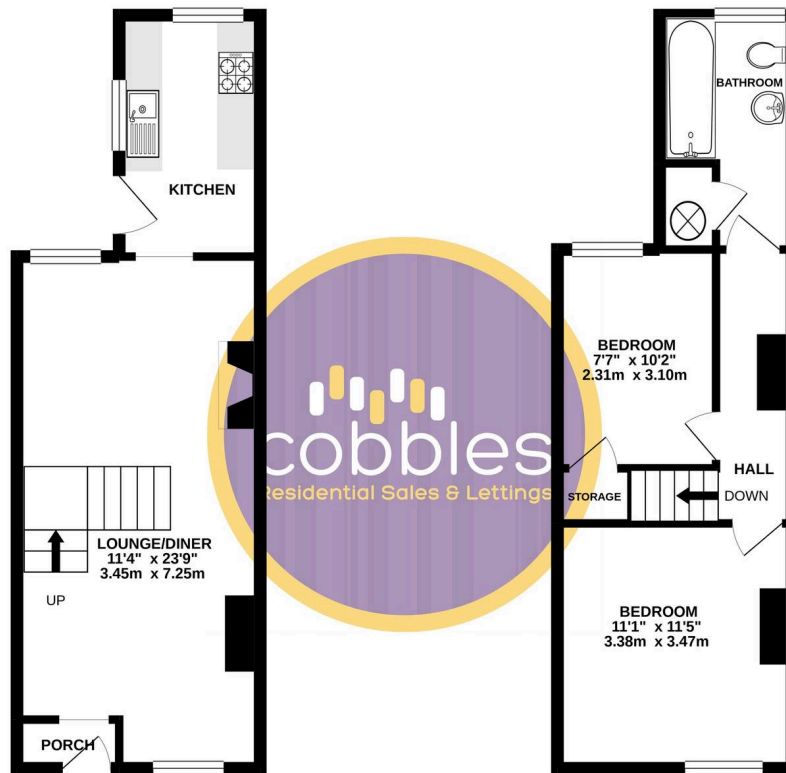

Stoughton Road

Guildford, Guildford

Council Tax band: C

Tenure: Freehold

EPC Energy Efficiency Rating: D

EPC Environmental Impact Rating: D

- South-Facing Garden
- Modern Family Bathroom
- Spacious Lounge/Diner
- Two bedroom House
- Council Tax Band - C
- EPC Rating - D

TOTAL FLOOR AREA : 653 sq.ft. (60.7 sq.m.) approx.

Whilst every attempt has been made to ensure the accuracy of the floorplan contained here, measurements of doors, windows, rooms and any other items are approximate and no responsibility is taken for any error, omission or mis-statement. This plan is for illustrative purposes only and should be used as such by any prospective purchaser. The services, systems and appliances shown have not been tested and no guarantee as to their operability or efficiency can be given.
Made with Mergepro ©2021

