



Southway

Guildford, Guildford

Council Tax band: C

Tenure: Leasehold

EPC Energy Efficiency Rating: C

EPC Environmental Impact Rating: C

- Three Bedrooms
- Private Garden
- Off Street Parking
- Close to Hospital
- Council Tax Band - C
- EPC Rating - C

GROUND FLOOR
108 sq.ft. (10.1 sq.m.) approx.

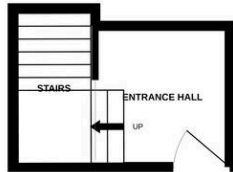

1ST FLOOR
570 sq.ft. (52.9 sq.m.) approx.



2ND FLOOR
362 sq.ft. (33.7 sq.m.) approx.



TOTAL FLOOR AREA: 1040 sq.ft. (96.6 sq.m.) approx.

Whilst every attempt has been made to ensure the accuracy of the floorplan contained here, measurements of doors, windows, rooms and any other items are approximate and no responsibility is taken for any error, omission or mis-statement. This plan is for illustrative purposes only and should be used as such by any prospective purchaser. The services, systems and appliances shown have not been tested and no guarantee as to their operability or efficiency can be given.
Made with Metropix ©2022

