

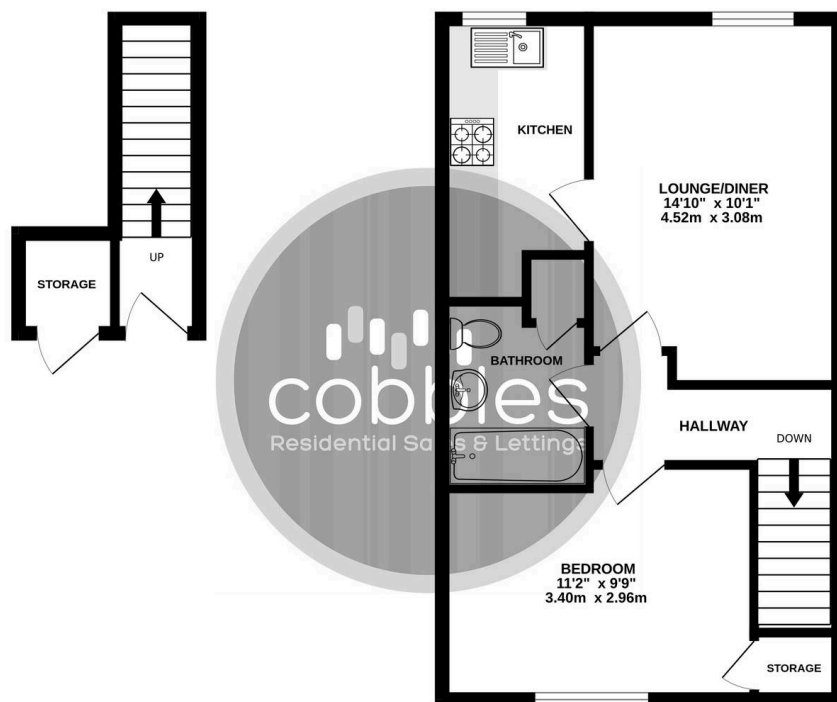



GROUND FLOOR  
38 sq.ft. (3.5 sq.m.) approx.

1ST FLOOR  
463 sq.ft. (43.0 sq.m.) approx.



TOTAL FLOOR AREA: 501 sq.ft. (46.5 sq.m.) approx.  
Whilst every attempt has been made to ensure the accuracy of the floorplan contained here, measurements of doors, windows, rooms and any other items are approximate and no responsibility is taken for any error, omission or mis-statement. This plan is for illustrative purposes only and should be used as such by any prospective purchasers. The services, systems and appliances shown have not been tested and no guarantee as to their operability or efficiency can be given.  
Made with Mergex ©2015

## Heather Close

Guildford, Guildford

Stunning ground floor maisonette in private road near Guildford Town Centre. Large lounge, equipped kitchen, family bathroom, double bedroom. Close to local amenities. Parking available.

Council Tax band: C

Tenure: Leasehold

EPC Energy Efficiency Rating: D

EPC Environmental Impact Rating: E

- Double Bedroom
- Private Entrance
- Ground Floor Maisonette
- Modern Throughout

