

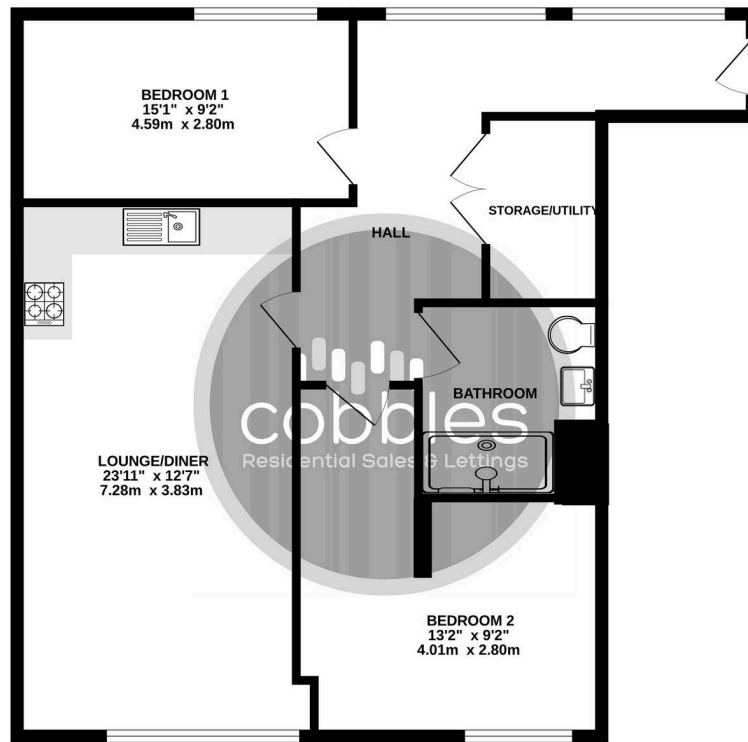

### THIRD FLOOR



## Norwich House, North Street

Guildford, Guildford

Council Tax band: TBD

Tenure: Leasehold

EPC Energy Efficiency Rating: C

EPC Environmental Impact Rating:

- Two Bedroom Flat
- Brand New
- Central Town Location
- Modern Throughout
- Community Incentive Scheme
- EPC Rating - TBC

Whilst every attempt has been made to ensure the accuracy of the floorplan contained here, measurements of doors, windows, rooms and any other items are approximate and no responsibility is taken for any error, omission or mis-statement. This plan is for illustrative purposes only and should be used as such by any prospective purchaser. The services, systems and appliances shown have not been tested and no guarantee as to their operability or efficiency can be given.  
Made with Mirogo ©2025

