

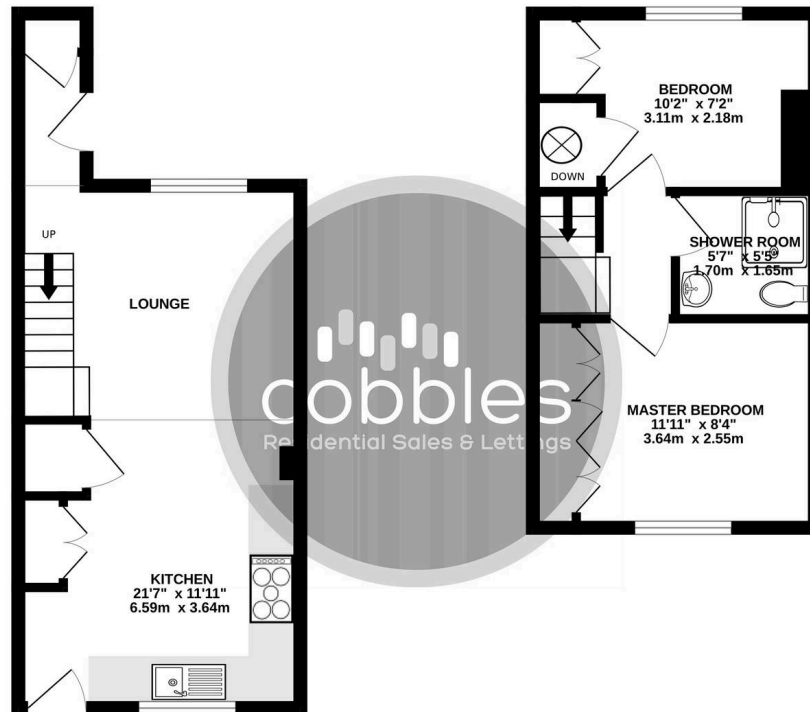

GROUND FLOOR
284 sq.ft. (26.4 sq.m.) approx.

1ST FLOOR
254 sq.ft. (23.6 sq.m.) approx.



TOTAL FLOOR AREA: 538 sq.ft. (50.0 sq.m.) approx.

Whilst every attempt has been made to ensure the accuracy of the floorplan contained here, measurements of doors, windows, rooms and any other items are approximate and no responsibility is taken for any error, omission or mis-statement. This plan is for illustrative purposes only and should be used as such by any prospective purchaser. The services, systems and appliances shown have not been tested and no guarantee as to their operability or efficiency can be given.
Made with Metropix ©2025

Summers Road

Godalming, Godalming

Council Tax band: G

Tenure: Freehold

EPC Energy Efficiency Rating: C

EPC Environmental Impact Rating: C

- Two Bedroom Terraced House
- Underfloor Heating
- Open Plan Living Space
- Private Patio
- Move in Before Christmas

