



## 2 Bedroom Luxury Apartment County Hall, Kingston upon Thames £910,000 Leasehold

Plot 301 Whittling Apartments, County Hall, Kingston upon Thames.

2 Bedroom Luxury Apartment - 927 sq ft located on the 3<sup>rd</sup> floor within the historic County Hall building, in Royal Kingston upon Thames.

Steeped in heritage, imagined for modern living. Introducing County Hall Kingston (CHK),

a stunning collection of one, two and three-bedroom apartments and duplexes within the Royal Borough of Kingston.

County Hall Kingston transforms the Grade II\* listed Surrey County Hall into a breathtaking residence, complete with contemporary new builds.

Live among a seamless blend of classic architecture and striking elegance.

Kingston station is within a 15-minute walk from County Hall, with services into London Waterloo taking around 29 minutes, and

services from nearby Surbiton taking under 20 minutes. The M25 and the A3 are nearby,

providing fast access to central London, Heathrow and Gatwick airports.

The town has top ranking educational facilities, with highly rated schools at every level,

including high performing grammar and independent schools at secondary level.

Kingston University London has over 20,000 students in total and is ranked a top 5 university in London in 21 subjects (2023 Guardian University Guide).

Contact us today for more information.

Please note, all images and floor plans are indicative.

[WWW.STACKANDBONNER.COM](http://WWW.STACKANDBONNER.COM)

020 8974 8844

[sales@stackandbonner.com](mailto:sales@stackandbonner.com)





# Apartment 301

2 BEDROOM | BUILDING WHITTLING APARTMENTS

THIRD FLOOR

APARTMENT 301

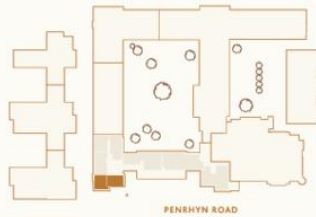

## ROOM DIMENSIONS

LIVING / KITCHEN / DINING ROOM  
6.37M X 4.75M | 20'11" X 15'7"

PRINCIPAL BEDROOM  
3.93M X 4.77M | 12'11" X 15'8"

BEDROOM 2  
4.19M X 2.74M | 13'9" X 9'0"

TOTAL INTERNAL AREA  
86.2 M<sup>2</sup> | 927.8 FT<sup>2</sup>



## KEY

OPTIONAL WARDROBE 2M  
ROOF LIGHT 1.5M

Total floor area may vary slightly to the figure that is listed. Wardrobes are included in the principal bedroom only, all other furniture is indicative and not supplied. Dotted lines indicate areas where ceiling heights may vary.

- County Hall, Kingston upon Thames
- Historic Landmark Development
- 2 Bedroom Luxury Apartment
- 3rd Floor of the Whittling Apartments
- 927 sq ft [approx]
- 24hr Concierge Service
- Collection of Amenities including a balance studio, picture house and games parlour
- Residents Private Courtyard
- 999 year lease
- Estimated - Service Charge: £5,033.61 plus £2,410.10 buildings insurance per annum
- All images and floor plans are indicative