



28 MAPLE ROAD

GRAYS, RM17 6LB

£300,000
FREEHOLD

Guide Price - £300,000 - £325,000 - This charming period three-bedroom period terrace house is ideally situated near Grays town centre, offering convenient access to local amenities and the C2C railway station. The property boasts two spacious reception rooms, perfect for family gatherings or entertaining guests.

The first-floor bathroom provides practicality and comfort for daily living, while the fitted kitchen is well-equipped for all your culinary needs.

Grays is a vibrant community with a variety of shops, local schools, and excellent bus routes. The C2C railway station conveniently connects you to London Fenchurch Street, making it an excellent choice for commuters.

tm
thomas marsh

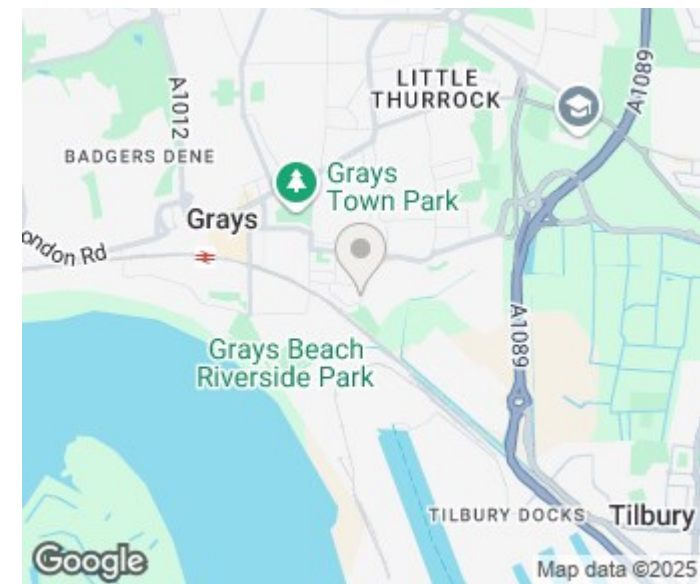
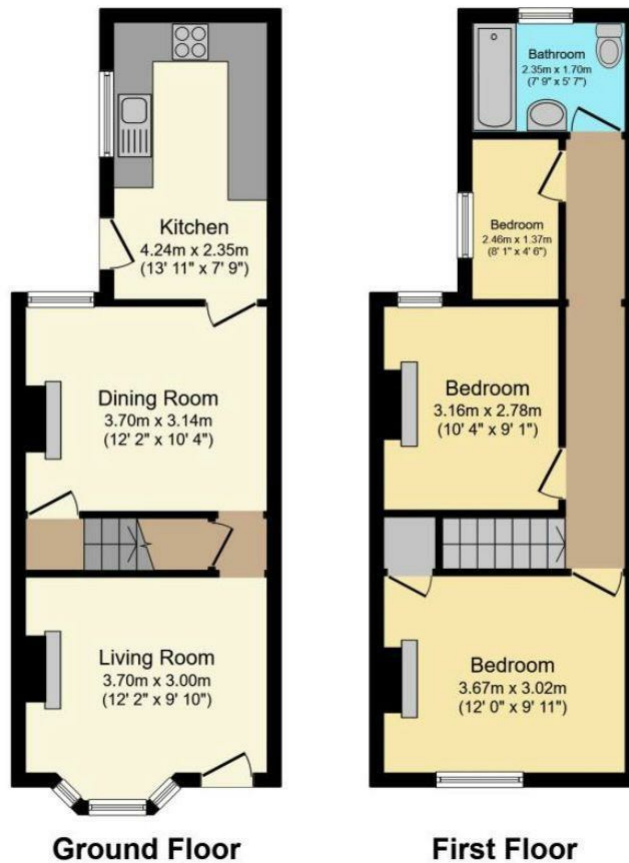

Energy Efficiency Rating		
	Current	Potential
Very energy efficient - lower running costs		
(92 plus) A		
(81-91) B		
(69-80) C		
(55-68) D		
(39-54) E	55	65
(21-38) F		
(1-20) G		
Not energy efficient - higher running costs		
England & Wales	EU Directive 2002/91/EC	

Agents Note: Whilst every care has been taken to prepare these particulars, they are for guidance purposes only. All measurements are approximate and are for general guidance purposes only and whilst every care has been taken to ensure their accuracy, they should not be relied upon and potential buyers/tenants are advised to recheck the measurements

Grays Sales
47 Orsett Road
Grays
Essex
RM17 5HJ

01375 370779
sales@thomas-marsh.com
www.thomas-marsh.com

