



34 Mitton Road, Whalley, BB7 9RX  
£399,950

 3  1  1  D



# 34 Mitton Road, Whalley, BB7 9RX

Benefiting from a stunning and sympathetic refurbishment throughout, this beautifully presented end-terrace offers an exceptional blend of period elegance and modern comfort. Characterised by high ceilings, stylish interiors, and a wealth of original features, the property delivers charm and practicality in equal measure. Carefully enhanced with oak internal doors, decorative coving, feature fireplaces, and newly installed cast iron radiators, the home retains its historic integrity while offering a turnkey finish ideally suited to contemporary living.

The accommodation is arranged over two floors and comprises three generously proportioned double bedrooms, a newly fitted kitchen, and a modern bathroom, all finished to an excellent standard. Off-road parking and open views to the rear further enhance the appeal, making this a home that truly stands out within its setting.

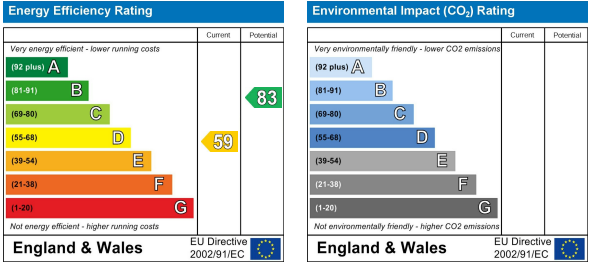
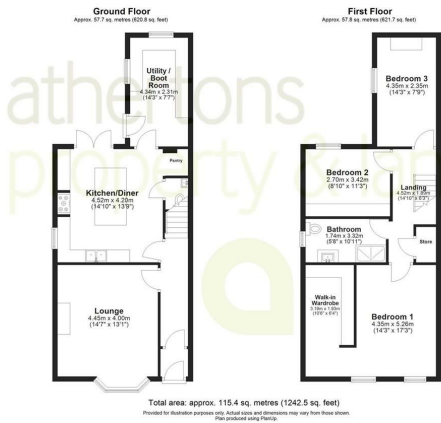

These particulars, whilst believed to be accurate are set out as a general outline only for guidance and do not constitute any part of an offer or contract. Intending purchasers should not rely on them as statements of representation of fact, but must satisfy themselves by inspection or otherwise as to their accuracy. No person in this firms employment has the authority to make or give any representation or warranty in respect of the property.